

# User Manual

## Adjustable Striking Plate Set **102930.0** for locking device "HD-Lock"

### 1. General

The striking plate set for the locking device HD-Lock allows alignment of the striking plate with the position of the bolt (see section 2.3). It consists of the striking plate itself, a toothed base plate which serves as a locking mechanism and an insulating layer to prevent galvanic corrosion.

### 2. Technical Specifications

#### 2.1 Material

Striking plate: 1.4404 (Stainless steel, V4A)  
Toothed base plate: 1.4404 (Stainless steel, V4A)  
Insulating layer: Coroplast 1056 PE

#### 2.2 Product Drawing

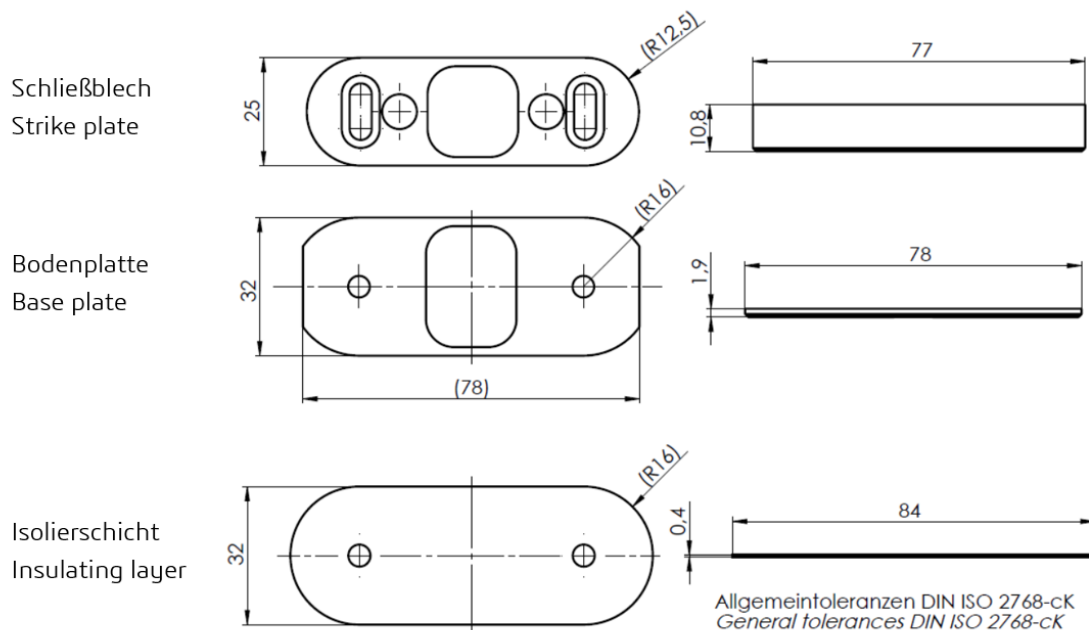

#### 2.3 Adjustment Range of the Striking Plate

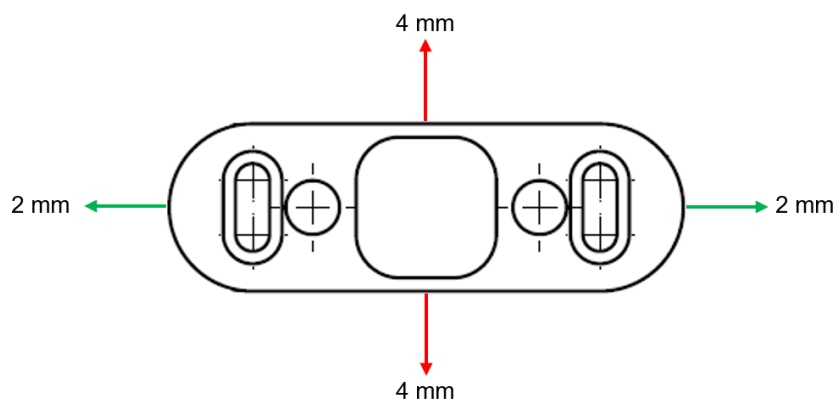

## 2.4 Recess in the door

The adjustable striking plate set is intended for use with the locking device HD-Lock. To ensure the intended function, the striking plate must be mounted in a recess corresponding to the illustration shown below.

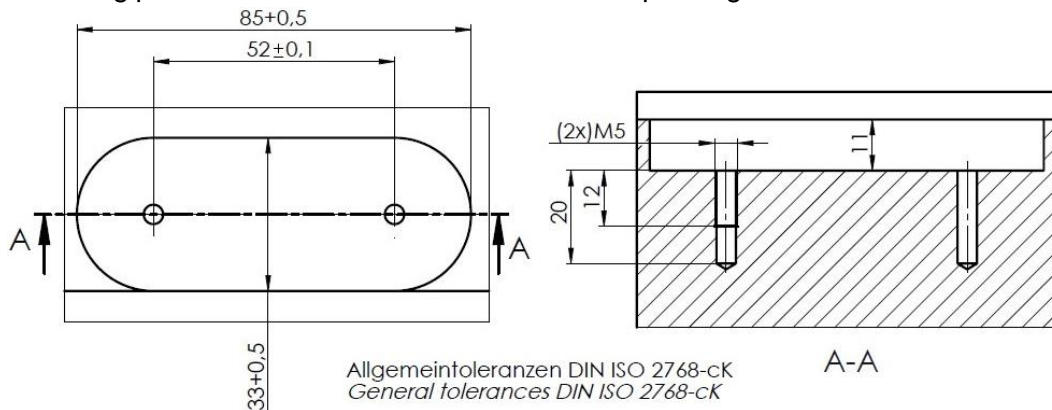

## 3. Installation

### 3.1 Layer Structure

Before installation of the adjustable striking plate set, the insulating layer must be glued to the smooth side of the base plate. Then the base plate can be placed in the recess. Make sure that there are no foreign objects under the base plate, otherwise the insulating layer could be damaged and the base plate will not lie straight. The striking plate can now be placed on the base plate with the toothed side facing down.

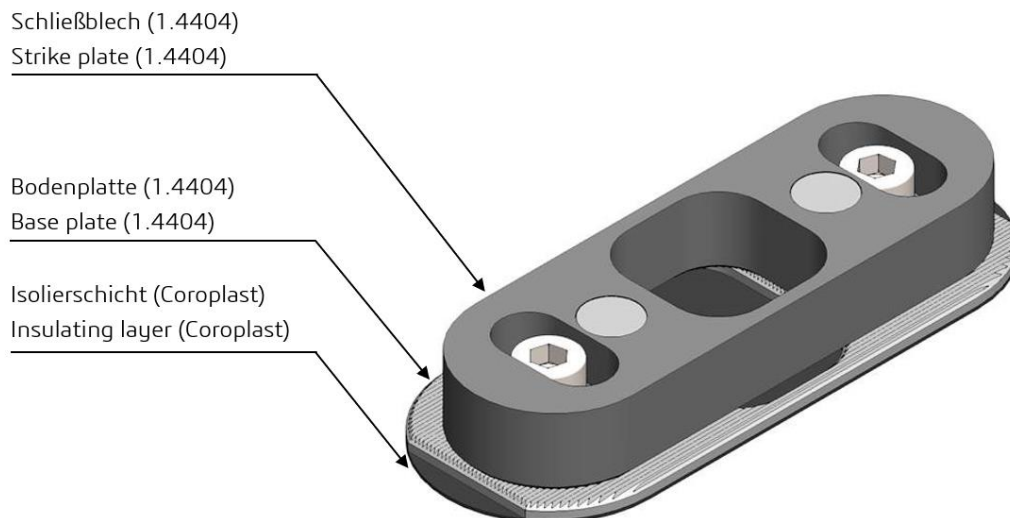

If the recess in the door is too deep and the maximum distance of 12 mm between the striking plate and the HD-Lock cannot be maintained, a spacer plate set (Art. No.: 102931.0) can be used to underlay the striking plate.

### 3.2 Alignment

For proper function it is important that the striking plate is correctly aligned. When the door is closed, the bolt of the HD-Lock must hit the hole in the striking plate in the middle. When used on ships exterior doors, even the offset caused by the door seal or the see waterproof function must not cause the bolt to touch the striking plate. If it is not possible to ensure that the bolt can be extended or retracted without streaking, the HD-Lock cannot be used properly. It must also be noted that the striking plate must be aligned lengthwise to the HD-Lock to ensure safe operation. BSS offers an adjustment aid (Art. No.: 102935.0) for proper alignment of the striking plate.

### **3.3 Clamping**

The tooth system between the base plate and striking plate are used to create a form fit between the two parts. This is only effective when the striking plate and the base plate are firmly pressed together by the screws. The tightening torque of the screws is 4 to 4.3 Nm. Attention: When the screws are tightened, the striking plate can shift. To counteract this, the striking plate can be pressed down by hand to fix it. Measures must be taken to prevent galvanic corrosion and loosening due to vibration.

### **3.4 Testing**

After installing the striking plate, check the correct function of the locking device HD-Lock. The following steps must be carried out for this purpose:

- Close the door (bolt must be engaged).
- Check the free movement of the bolt
- Let the bolt extend and then activate the sea waterproof function.
- Check the free movement of the bolt
- Let the bolt extend and operate the door handle (the door can now be pushed open through the door seal).
- Check the free movement of the bolt

If all the steps described above have not caused the bolt to jam or strip, the striking plate is properly aligned and the HD-Lock is ready for use.

### **3.5 Troubleshooting**

- Is the door still adjusted in the same way as when the striking plate was installed?
- Has the sequence of layers been stuck to?
- Has a foreign object got under or between the layers?
- Are the base plate and striking plate positioned so that the toothed sides face each other?
- Is the striking plate correctly aligned in the door (are all tests passed)?
- Are the screws tightened?
- Has the distance from the striking plate to the HD-Lock been maintained?

